



Excellent adhesion to standard substrates, good adaptation to the contours of component junctions thanks to high modellability: the blaugelb Foil Vario **SL²⁰⁵⁰** Single-Sided.



blaugelb Foil Vario **SL²⁰⁵⁰** Single-Sided

Reliable protection for connecting joints.

Product features:

The blaugelb Foil Vario **SL²⁰⁵⁰** Single-Sided forms a barrier that is airtight, impervious to driving rain and windproof across the connection and expansion joints between windows and doors and the adjacent wall materials, depending on the application.

It is primarily intended for use on the outside of windows and doors, but can also be used inside. Thanks to its performance characteristics, it can be used in a wide range of situations in both renovation and new-build projects (see drawing icons). Installing it as a second layer of waterproofing beneath the window sill is another possible application.

The blaugelb Foil Vario **SL²⁰⁵⁰** Single-Sided is available in a wide range of widths and can therefore be used in widths from 75 mm to 350 mm for seal-

Continued on
the next page 

- Exceptional adhesion to standard wall building materials and framing materials
- Immediate adhesion, even where layers overlap
- High tear resistance, yet easy to shape for forming corners and transitions
- The blaugelb Foil Vario **SL²⁰⁵⁰** Single-Sided is watertight against driving rain up to $\geq 2,050$ Pa (EN 12208)
- UV-resistant for 12 months
- Waterproof up to 10,000 Pa



ing everything from window joints to sections of the façade. The fleece side is waterproof against driving rain and can be easily installed in the weather zone. When the adhesive is applied to the outside and outdoor humidity is high, the non-woven side seals itself, preventing any moisture from entering the building or the joint.

When installed on the room side and there is high indoor humidity, the non-woven side opens up towards the room, allowing the humidity to escape from the building.

Handy finger lift for efficient application



Product benefits:

- Waterproofing that is resistant to driving rain and wind, airtight, and open to vapour diffusion for outside and inside waterproofing zones in accordance with DIN 18355; DIN 18360; DIN 4108-BBL2; DIN 4108-T7; RAL "LzM"
- Water vapour diffusion permeability (from the adhesive side) is diffusion-open, $s_d \leq 0.5$ m (in accordance with DIN 4108-3)
- Water vapour diffusion permeability (from the non-woven side) is diffusion-resistant, $s_d \geq 10$ m (in accordance with DIN 4108-3)
- The adhesive strength ensures exceptional adhesion
- Immediate adhesion, even in case of overlapping
- Fully adhesive on one side
- High tear resistance, yet easy to shape for forming corners and transitions
- Can be plastered over, covered with adhesive tape and painted over
- Concealed installation within the structure, e.g. beneath mouldings or pilaster strips, is possible
- UV-resistant for 12 months
- Watertight against driving rain over 2,050 Pa
- Flexible and elastic, compensates for joint movements
- Moisture and temperature-resistant
- Easy to apply thanks to overlapping, perforated backing paper (finger lift)
- Joint sealing compliant with the "Leitfaden zur fachgerechten Montage" [Guideline for Proper Installation] and the German Building Energy Law (GEG)
- Tested to be very low in emissions according to EMICODE EC1 Plus

Technical data:

Material:	Non-woven-backed plastic polymer foil, single-sided adhesive
Building material class: DIN EN 13501	Class E
Self-adhesive:	Yes
Water vapour diffusion permeability: (from the adhesive side) DIN EN ISO 12572	Breathable, $s_d \leq 0.5$ m
Water vapour diffusion permeability: (from the fleece side) DIN EN ISO 12572	Diffusion-resistant, $s_d \geq 10$ m
Joint permeability coefficient: DIN EN 12114	$a < 0.1 \text{ m}^3/[\text{h} \cdot \text{m} \cdot (\text{daPa})^{2/3}]$, airtight in accordance with RAL-LzM requirements
Watertightness against driving rain: DIN EN 1027	$\geq 2,050$ Pa
Watertightness:	$\geq 10,000$ Pa
UV stability:	12 months
Temperature resistance:	From approx. -40 °C to $+90$ °C
Ambient temperature during handling:	-10 °C to $+45$ °C
Substrate temperature during application:	From -10 °C (ice-free)
Compatibility with adjacent building materials:	Satisfied
Storage temperature:	At $+0$ °C to $+30$ °C
Shelf life:	18 months with dry storage in unopened original packaging
Colour:	Black

Item name	PU	Item no.
blaugelb Foil Vario SL²⁰⁵⁰ Single-Sided 75 mm single perforation	8 x 40 m	9384640
blaugelb Foil Vario SL²⁰⁵⁰ Single-Sided 90 mm single perforation	6 x 40 m	9384641
blaugelb Foil Vario SL²⁰⁵⁰ Single-Sided 120 mm double perforation	4 x 40 m	9384643
blaugelb Foil Vario SL²⁰⁵⁰ Single-Sided 150 mm double perforation	4 x 40 m	9384664
blaugelb Foil Vario SL²⁰⁵⁰ Single-Sided 200 mm double perforation	2 x 40 m	9384665
blaugelb Foil Vario SL²⁰⁵⁰ Single-Sided 250 mm double perforation	2 x 40 m	9384666
blaugelb Foil Vario SL²⁰⁵⁰ Single-Sided 300 mm double perforation	2 x 40 m	9384667
blaugelb Foil Vario SL²⁰⁵⁰ Single-Sided 350 mm double perforation	2 x 40 m	9384668

Preparation and processing:

The blaugelb Foil Vario **SL²⁰⁵⁰** Single-Sided must be brought to the specified storage temperature prior to processing. Under these conditions, the blaugelb Foil Vario **SL²⁰⁵⁰** Single-Sided can be installed at ambient temperatures of -10 °C or above. The surface must be solid, dry, clean and free of grease, separating agents, solvents, dust, ice, white frost and loose parts. The substrate and PVC profiles must be free of moisture/condensate.

Before application, the suitability of the material for the intended application is to be verified through appropriate tests performed by the customer. On porous, sandy or damp substrates, adhesion can be improved by pre-treating the surface with a suitable primer (blaugelb Spray Primer, item no. 9066539).

The blaugelb Foil Vario **SL²⁰⁵⁰** Single-Sided is designed for single-sided use. The self-adhesive guarantees outstanding adhesion on commercially available window profiles and construction substrates. The foil is flexible and



stretchy. Pressing the foil down during installation is crucial for activating its self-adhesive properties. It ensures a very high level of long-lasting adhesion to the substrate, even when working overhead.

Unwind the blaugelb Foil Vario **SL²⁰⁵⁰ Single-Sided** from the roll and cut it to the required length, adding approx. 5 cm. Remove the perforated protective paper on the fully adhesive side and bond the foil to the frame. Firmly press the blaugelb Foil Vario **SL²⁰⁵⁰ Single-Sided** onto the window profile.

Completely fill the centre functional level with the intended insulation material. Then bond the blaugelb Foil Vario **SL²⁰⁵⁰ Single-Sided** to the substrate without stretching with the wide self-adhesive strip, forming a sufficient expansion loop. [Note on the movement loop as an installation requirement: see DIN 4108-T7 / RAL Installation Guide 2024-03]. In the corners of the soffit, the membrane should be installed in a trough-like shape with an overlap of approx. 30–50 mm (taking into account the widths of the joints to be sealed). The “corner bowl formation” thus achieved is to be recommended. The recommendations from the technical bulletin “Verputzen von Fensteranschlussfolien”: 2016-08 (Plastering of Window Connection Foils) should be observed for the bonding width in the jamb area. Firmly press the blaugelb Foil Vario **SL²⁰⁵⁰ Single-Sided** onto the substrate. The blaugelb Pressure Roller (item no. 9074068) is suitable for pressing on to the window frame and the substrate.

Note on correct installation:

Make sure to prevent any leaks through open areas. The convection that occurs there carries 1,000 times more moisture into the structure than can escape through planned diffusion.

Delivery and storage form:

Store in the original packaging in a dry place and protect against effects of frost and heat. Can be stored for 18 months at a storage temperature between +0 °C and +30 °C.

Disposal:

Scraps of the blaugelb Foil Vario **SL²⁰⁵⁰ Single-Sided** can be disposed of in the household waste. The disposal generally conforms with the national and local specifications.

Safety note:

According to the available specifications and guidelines, the product is not a hazardous substance.

This figure shows the effect of the non-woven and self-adhesive sides:
 The non-woven side is diffusion-resistance (sd value ≥ 10 m), water-impermeable ($\geq 10,000$ Pa) and UV-resistant.
 The self-adhesive side is open to vapour diffusion.

Requirements:

GEG 2024; DIN 4108-7; EN 12207;
 DIN18355; DIN18360

- Resistant to vapour diffusion, sd value ≥ 10 m
- Water impermeability $\geq 10,000$ Pa
- UV resistance: 12 months

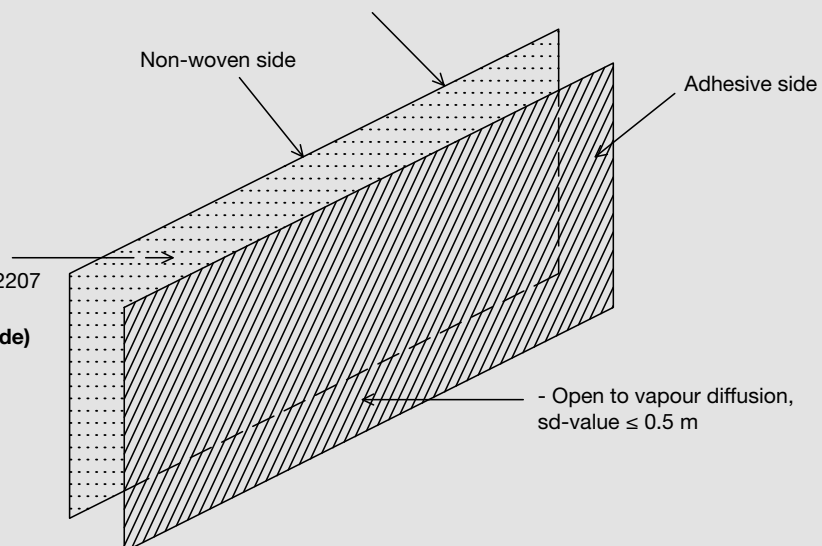

Airtightness zone (room side)
 - Airtightness in accordance with EN 12207

Weather-protection zone (weather side)
 - Watertightness against driving rain (DIN EN 12208)
 - Wind resistance

- Open to vapour diffusion, sd-value ≤ 0.5 m

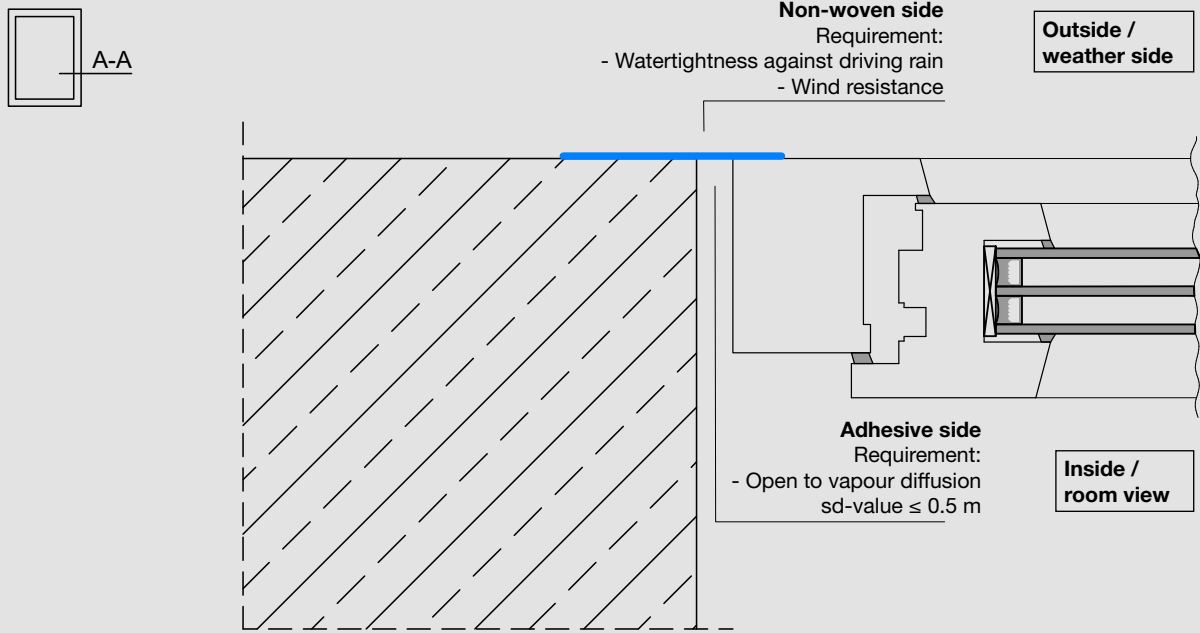

The drawings merely illustrate the intended use of the foil. Other sealing layers are not taken into account.

